

# Combination Magnet Contact

## AMS-13

## Product Specifications

### 1. Features

- 5/8" operating gap (face to side)
- 3/4" operating gap (Parallel array)
- Magnet type: Alnico 5
- 12" leads AWG #22
- Colors : Brown or White



### 2. Dimensions

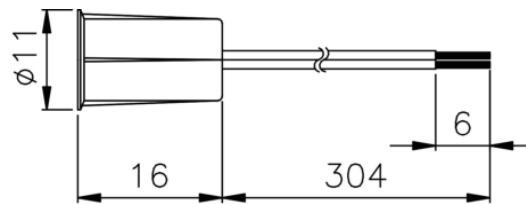
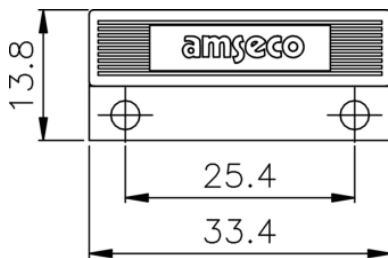

### 3. Specifications

Model Number	Operating Gap	Contact	Contact Type	Max. Switching Current	Max. Carry Current	Breakdown Voltage	Rating	Magnet Type	Mounting Method
AMS-13	5/8"	12"Lead	N.O	0.1A	0.3A	150V DC	1.0VA	Alnico 5	Press fit Or Flange Mount